

Ottawa County, Ohio - Property Record Card

Parcel: 0131469719774015 Card: 1

Owner MEAD DAVID & CAROL D S&T
Address 2841 N BLUFF RIDGE
Land Use (510) R - SINGLE FAMILY DWELLING, PLATTED LOT
Class RESIDENTIAL
Legal Description LOT 13 THE BLUFFS PLAT 2
Tax Mailing Name MEAD DAVID & CAROL D LENDER#41417
Tax Mailing Address 2841 N BLUFF RIDGE DR, PORT CLINTON OH 43452

MAP



SKETCH

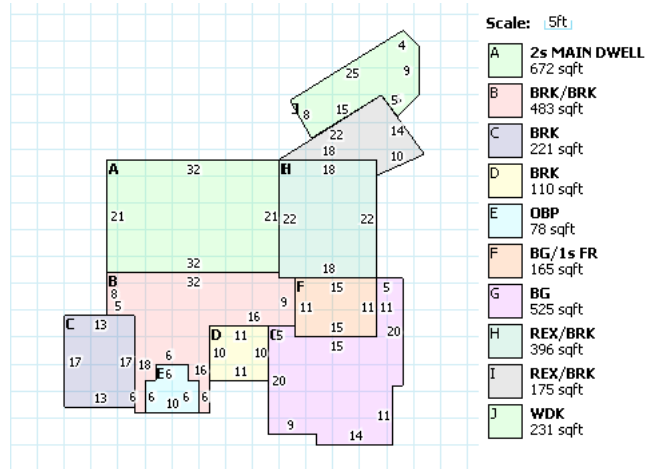

RESIDENTIAL

Building Style		FullBaths	4
Sq.Ft.	4049	Half Baths	1
Year Built	1993	Basement	FULL
Stories	2	Basement Area	672
Exterial Wall	STONE	Rec Room Area	0
Rooms	11	Heat Fuel Type	GAS
Bedrooms	5	Heat/Cool	CENTRAL AIR CONDITION
Family Rooms	0	Attic	NONE
Fireplace Openings(Stacks)	0(0)	Trim	0

LAND

Code	Frontage	Depth	Acreage	SqFt	Value
4	100	288	N/A	N/A	\$400,680.

VALUATION

	Appraised	Assessed
Land Value	\$400,680.00	\$140,240.00
Building Value	\$444,620.00	\$155,620.00
Total Value	\$845,300.00	\$295,860.00
CAUV Value	\$0.00	
Taxable Value	\$295,860.00	

PERMITS

Number	Date	Purpose	Amount
16R33326	26-OCT-16	ALTER	

IMPROVEMENTS

SALES

Date	Buyer	Seller	Price	Validity
4/14/2014	MEAD DAVID & CAROL D	REDFERN KIMBERLY I & CHRIS	\$835,000.000	VALID SALE
4/12/2010	REDFERN KIMBERLY I & CHRIS	HOME DESIGNS BY KIM BERLY LLC	\$0.00	8 UNVALIDATED
12/22/2006	HOME DESIGNS BY KIM BERLY LLC	BEST JAMES R & LINDA L S&T	\$900,000.000	VALID SALE
12/18/1998	BEST JAMES R & LINDA L S&T	NEHLS ROBERT L & NORMA J	\$600,000.000	VALID SALE
10/27/1992	NEHLS ROBT L DVM & NORMA J	MIDLAND TITLE AGENCY INC	\$165,000.000	VALID SALE
10/27/1992	NEHLS ROBT L DVM & NORMA J	MIDLAND TITLE AGENCY INC	\$165,000.000	VALID SALE